

KING SHAKA INTERNATIONAL AIRPORT (FALE)

FALE | Public — International airport

| | |
|-------------|--------------------------------|
| Coordinates | S29°36'43" E31°07'10" |
| Elevation | 304 ft AMSL |
| Frequency | 118.45 MHz |
| Access | Public — International airport |
| Fuel | JET A-1, AVGAS 100LL |
| Night Ops | Yes |
| Tower Phone | +27 32 436 5001 |

Frequencies

| | |
|-----------------|-------------------|
| Durban Tower | 118.45 MHz |
| Durban Approach | 125.75 MHz |
| Durban Ground | 121.65 MHz |
| Durban ATIS | 127.0 MHz |

Runways

| RWY | Length | Width | Surface | Strength | Circuit |
|-----------------|------------|-------|---------|----------|---------|
| 06/24 | 3,700 m | 60 m | Asphalt | PCN 80 | Left |
| Service | Frequency | | | | |
| Durban Tower | 118.45 MHz | | | | |
| Durban Approach | 125.75 MHz | | | | |
| Durban Ground | 121.65 MHz | | | | |
| Durban ATIS | 127.0 MHz | | | | |

[!] [!] Controlled airspace — Class B TMA, Class C CTR

- Major international airport — heavy jet traffic
- Opened 2010, replacing old Durban International (FADN)
- VFR traffic must contact Approach and follow published VFR routes
- Sugar cane fires in vicinity can reduce visibility
- ~600 nm northeast of Cape Town

Contact: King Shaka ATC, Tel: +27 32 436 6000

Aerodrome Diagram

**AERODROME/
HELIPORT
CHART - ICAO**

29°36'42.38"S **ELEV 304'**
031°07'09.53"E **GUND 92.2'**

RADAR APP 125.75
TWR 118.45
GND 121.65
ATIS 127.00

DURBAN
(KING SHAKA INTERNATIONAL)
FALE

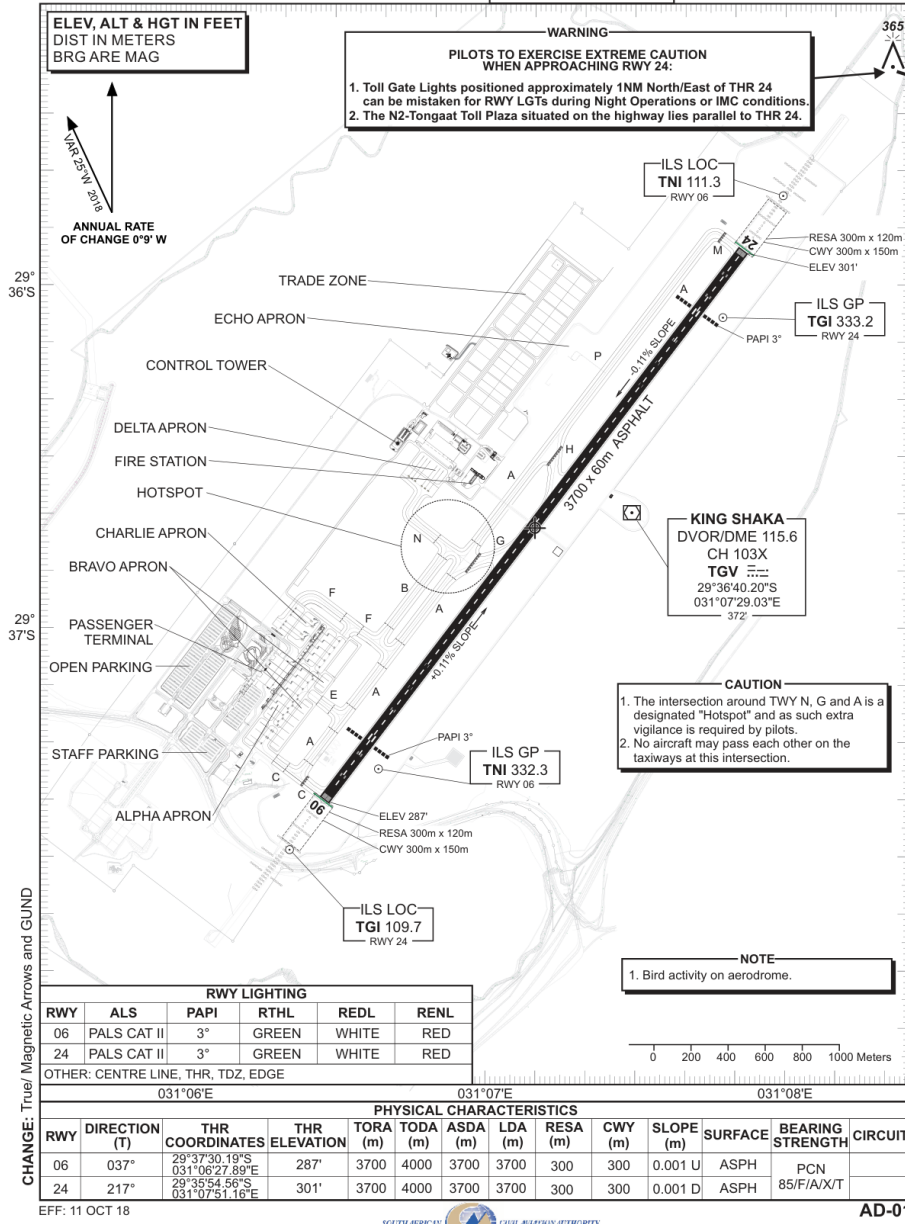

Verify currency against official AIP

Data source: SACAA AIP (collected 2026-03-19)

SUPPLEMENTARY REFERENCE ONLY — Does NOT replace SACAA AIP, NOTAMs, or official aerodrome charts. Verify all data before flight. Use entirely at your own risk. | waygu.wings